

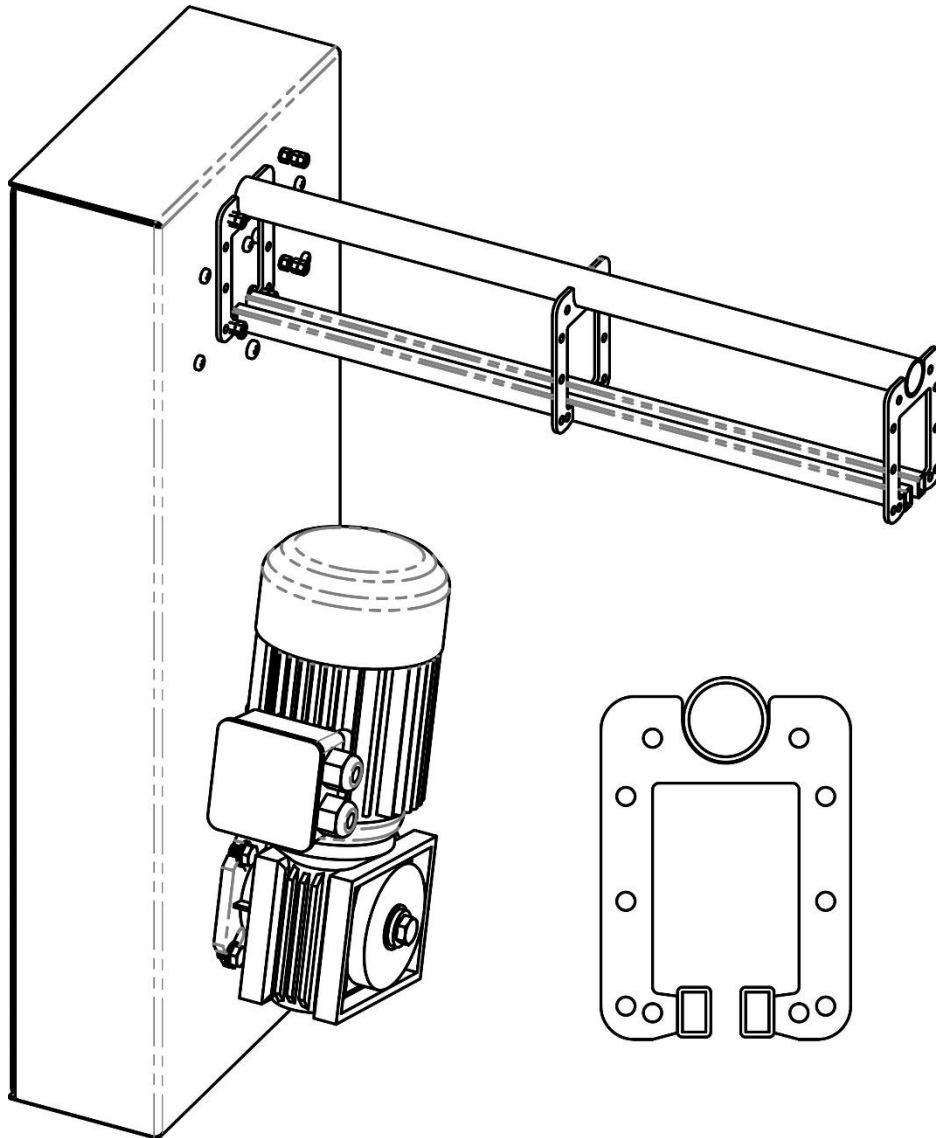

Engineering Ltd

Six Track User Manual



IMPORTANT – READ CAREFULLY BEFORE USE – KEEP FOR FUTURE REFERENCE

User Manual Revision 5 Issued April 2022

Doughty Engineering Ltd
Crow Arch Lane, Ringwood, Hampshire BH24 1NZ
Tel: +44 (0) 1425 478961

sales@doughty-engineering.co.uk
www.doughty-engineering.co.uk

Contents

- 1) SAFETY NOTES..... 3
- 2) GENERAL..... 3
- 3) SIX TRACK RANGE..... 4
- 4) LIMITATIONS OF USE..... 5
- 5) MODIFICATION..... 5
- 6) SAFETY INFORMATION 5
- 7) TRANSPORT AND STORAGE 5
- 8) INSTALLATION & OPERATION..... 6
- 9) COMMISSIONING..... 23
- 10) MAINTENANCE & INSPECTION..... 23
- 11) IF THE PRODUCT IS NO LONGER NEEDED 24
- 12) WARRANTY 24
- 13) INSTALLATION / INSPECTION REPORT 25
- 14) EC DECLARATION..... 26

1) SAFETY NOTES

BEFORE installing and operating Six Track, please read this manual carefully and pay attention to the information provided. Use this manual to familiarise yourself with the Six Track, its proper use and safety regulations.

DANGER

DANGER: Indicates a hazardous situation which, if not avoided, will result in death or serious injury. This signal word is to be limited to the most extreme situations.

WARNING

WARNING: Indicates a hazardous situation which, if not avoided, could result in death or serious injury.

CAUTION

CAUTION: Indicates a hazardous situation which, if not avoided, could result in minor or moderate injury.

NOTICE

NOTICE: address practices not related to personal injury.

SAFETY INSTRUCTIONS

SAFETY INSTRUCTIONS: is used for lists of steps, procedures or instructions that might otherwise substitute a DANGER, WARNING or CAUTION notification.

2) GENERAL

Six Track is a modular curtain track system suitable for a wide range of stage and studio applications.

Six Track kits include all the components required to install your chosen track length.

A typical kit comprises track, end stops, ball raced runners, adjustable support brackets and a fixing kit.

Line operated track kits also include a master runner, pulleys, hauling line, line supports, and a weighted hand pulley.

In addition, line operated track kits with overlap include a second master runner, overlap brackets and overlap pulleys.

The Six Track Variable Speed Track Drive is a single-phase rail mounted drive system. The wall mounted control box enables a variable speed drive system. An optional open/close remote-control unit is also available.

Six Track is strictly for professional use. Only competent persons are permitted to install and use Six Track. A competent person in this respect is an individual with relevant technical education, training and/or experience enabling him or her to perceive risks and to avoid hazards occurring during use of a product.

Doughty has endeavoured to deliver the highest degree of accuracy possible. However, continuous improvement of our products is a Doughty Policy. Therefore, product specifications are subject to change without notice.

Readers and users are encouraged to notify Doughty of errors and send in suggestions for improvement. All communications will be carefully considered for future printings of this manual and changes to our products.

3) SIX TRACK RANGE

Six Track is a curtain track system made up from a variety of interchangeable parts to form a flexible, efficient system.

Six track can be configured as:

1) A Walk-along System.

This is a system where a person opens/closes the curtains/drapes manually by pulling the curtain cloth. This system can be straight or curved and a single swipe or a system with an overlap.

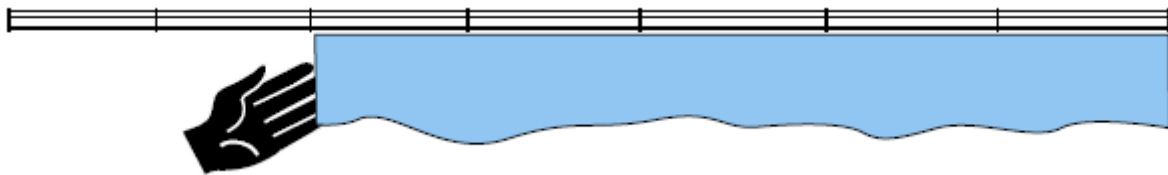

2) A Manual Line Operated System.

This system is operated with an 8mm polyester hauling line. The hauling line can be operated by hand or with a wall or floor mounted Manual Track Drive. This system can be straight or curved being a single swipe or an overlap system.

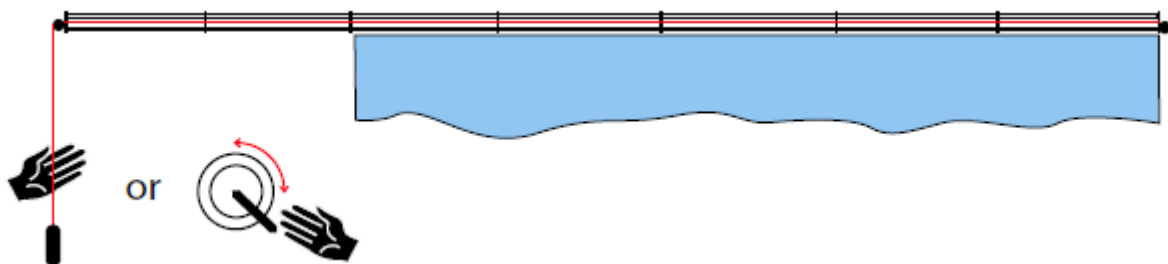

3) A Variable Speed Motorised System.

This system is operated with an 8mm hauling line. The hauling line is operated by an electric track drive in conjunction with limit switches to set the travel. This system can be straight or curved being single swipe or an overlap system.

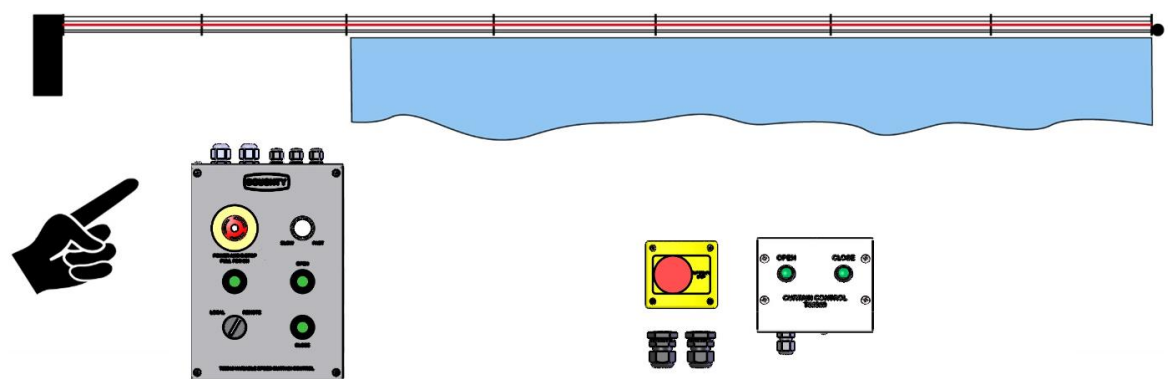

The Variable Speed Track Drive is mounted at one end of the rail and has a wall mounted control box. An optional open/close remote-control unit is also available.

4) LIMITATIONS OF USE





- Six Track can be operated in -20° Celsius up to +60° Celsius.
- Six Track is for indoor use only.
- The use of Six Track is the sole responsibility of the user.
- To use Six Track the user must observe the instructions to be found in this manual.
- All persons who use Six Track must be acquainted with this manual and must be informed about its potential hazards.
- It is also imperative to observe the local accident prevention regulations and/or occupational health and safety regulations.
- The manufacturer is not liable for indirect consequential damage and financial loss. The manufacturer shall not be liable for any changes made to the device nor for any damage resulting from such changes.

5) MODIFICATION

Six Track components should not be modified in any way. If there is a requirement for non-standard Six Track parts for a special purpose please contact your Doughty agent.

6) SAFETY INFORMATION

WARNING

-  Do not exceed any working load limit indicated.
-  Six Track shall be inspected by a competent person as often as required but with a minimum of once a year and maintain written records.
-  Six Track must be taken out of service immediately if, during use, repair or maintenance any serious damage is discovered.
-  Repairs can be undertaken only by authorised (Doughty trained) personnel. If in any doubt contact the manufacturer.

7) TRANSPORT AND STORAGE

- Before Six Track systems are put into storage they must be checked for defects. Defective Six Track components must be clearly marked and put aside so they cannot be re-used.
- Ensure the product is stored and kept in a dry, ventilated place to avoid corrosion.

8) INSTALLATION & OPERATION

- Installation should only be carried out by a competent person familiar with this type of equipment.
- All suspension points must be assessed to ensure they are adequate to suspend the load.
- A typical Six Track will be installed at a height such that any failure could be hazardous.
- Before starting the installation, the load for each support should be calculated allowing for the weight of all the track and accessories as well as the curtain whether open or bunched or part bunched as during opening. Care must be taken to allow for loads imposed during operation, the load on a twin head pulley may be increased by up to 50kg because of the hauling line.
- The maximum recommended length of a single span track is 10.0 metres and 18.0 metres for an overlap track system.
- The maximum distance between track supports is approximately 2.25m for open cloth and approximately 1.60m for bunched cloth.
- The maximum load per runner is 6kg and has a recommended spacing of 300mm when the cloth is open. Swivel hooks are best used on the curtains instead of eyelets or ties.

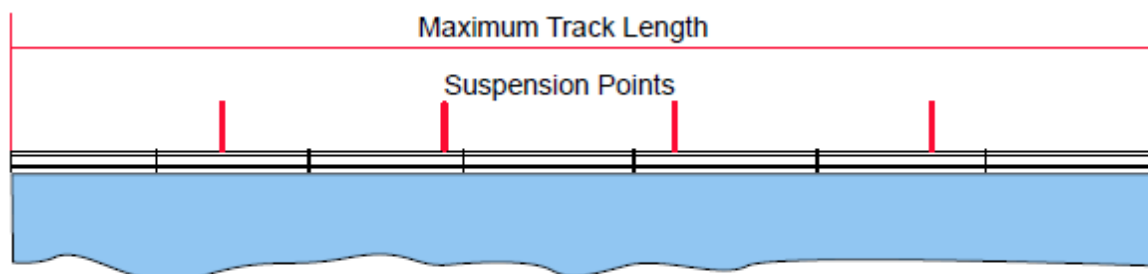

A Typical Swivel Hook

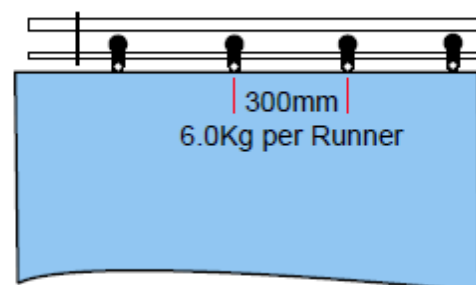

Six Track Straight Sections.

The following straight sections are available:

T63705	0.25m Straight
T63706	0.50m Straight
T63707	0.75m Straight
T63708	1.00m Straight
T63710	2.00m Straight
T63715	3.00m Straight

Custom lengths can be made to order or the track can be cut to length on site and used with a Bolt On End Plate or a Adaptor Plate. Each Six Track Straight section is supplied with a joint plate to aid alignment.

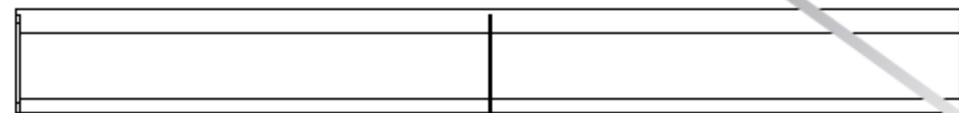
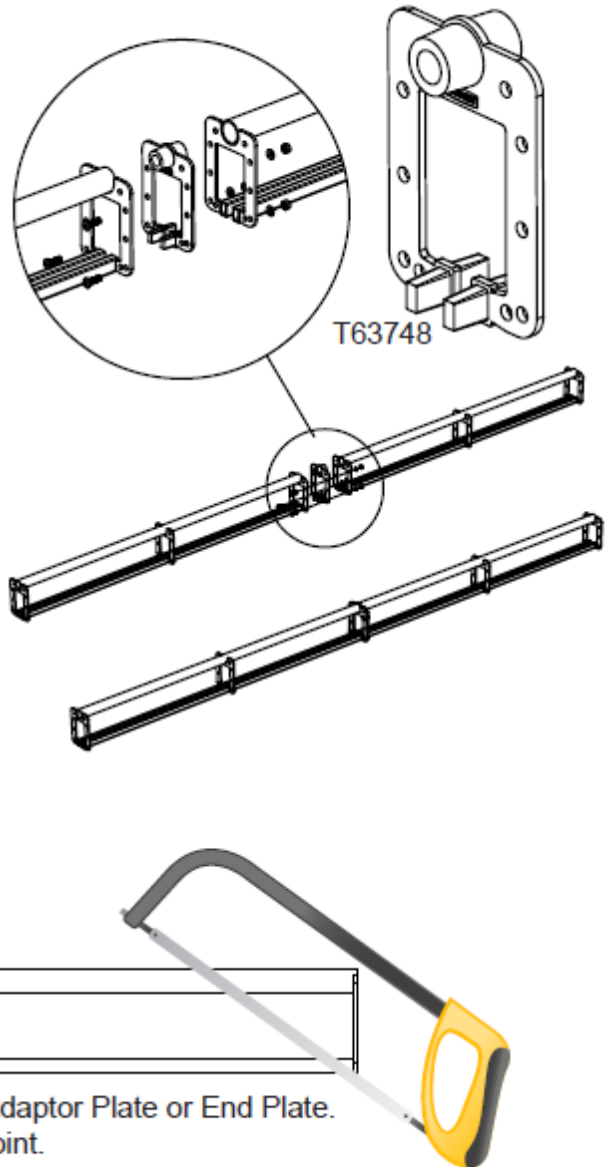

Six Track can be cut on site & fitted with an Adaptor Plate or End Plate. A minimum of four fixings are required per joint.



T63765: Bolt On End Plate

The Bolt On End Plate is used to terminate a cut section of Six Track.

Two 5mm diameter holes are required to be drilled.



T63766: Adaptor Plate

The Adaptor Plate is used on track sections which have been cut to be used mid track and require the runner to pass through.

Six Track Curved Sections.

The following curve sections are available:

T63730	0.50m x 90°
T63733	0.60m x 90°
T63731	0.75m x 90°
T63734	0.90m x 90°
T63732	1.00m x 90°
T63738	2.00m x 90° (2 parts)
T63739	3.00m x 90° (3 parts)
T63735	0.50m x 45°
T63736	0.75m x 45°
T63737	1.00m x 45°

Custom curves can be made to order.

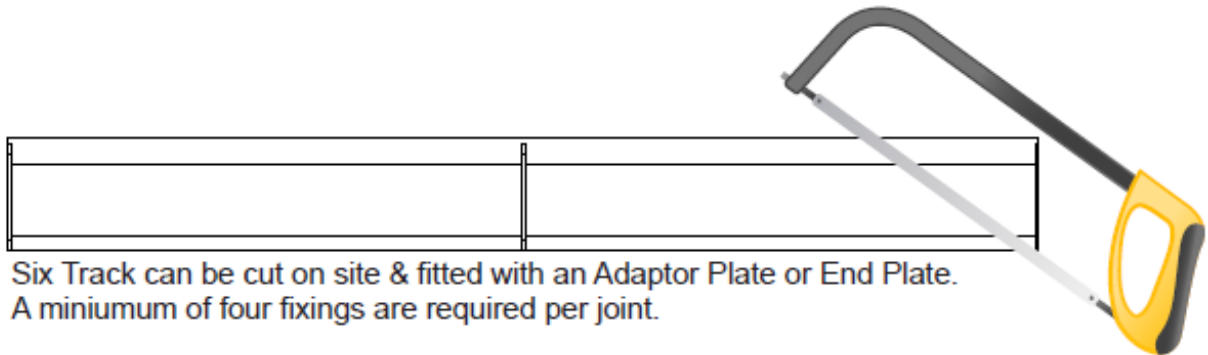
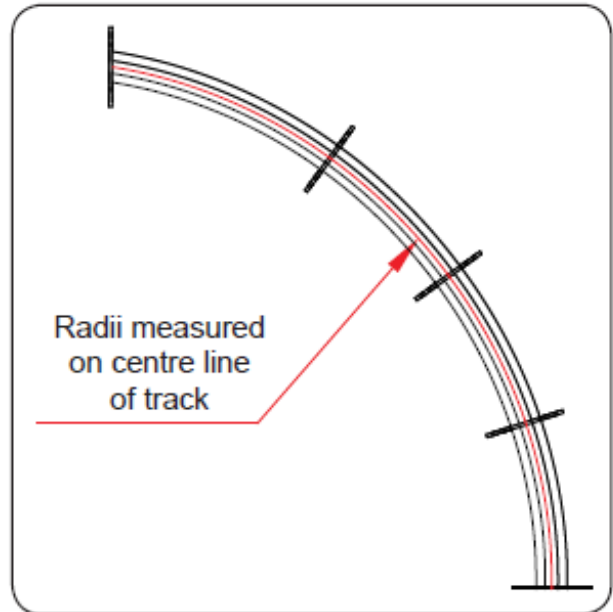

Six Track can be cut on site & fitted with an Adaptor Plate or End Plate. A minimum of four fixings are required per joint.

Six Track Runners have a SWL of 6Kg and are recommended to be used at 300mm intervals.

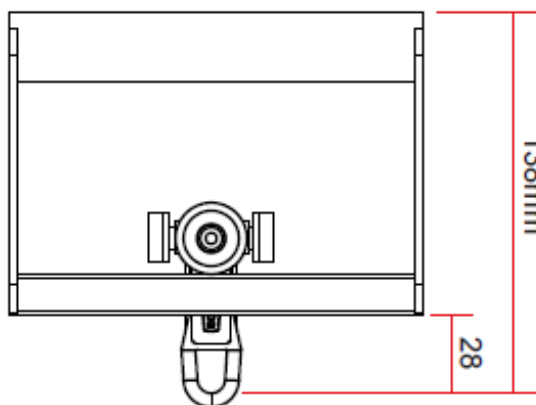

T63756: Ball Raced Runner
T63757: Plain Runner

A Master Runner is used to lead the curtain on every system, Walk-along, Line operated and Electric track drive.

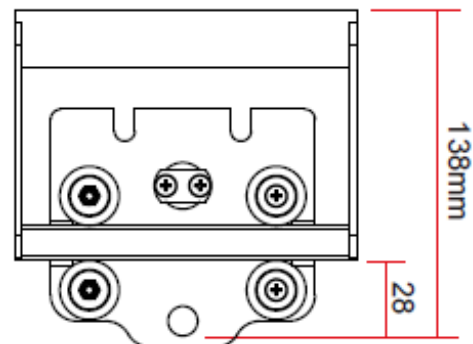

T63755: Master Runner

Nylon twin hooks (T63796) are used to connect curtains to Six Track runners

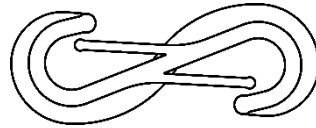

Six Track is suspended by attaching clamps/brackets to the Ø25mm top tube of the rail sections.

There are a variety of brackets available to cover most install situations.

Care must be taken to ensure all suspension points are adequate to suspend the load.

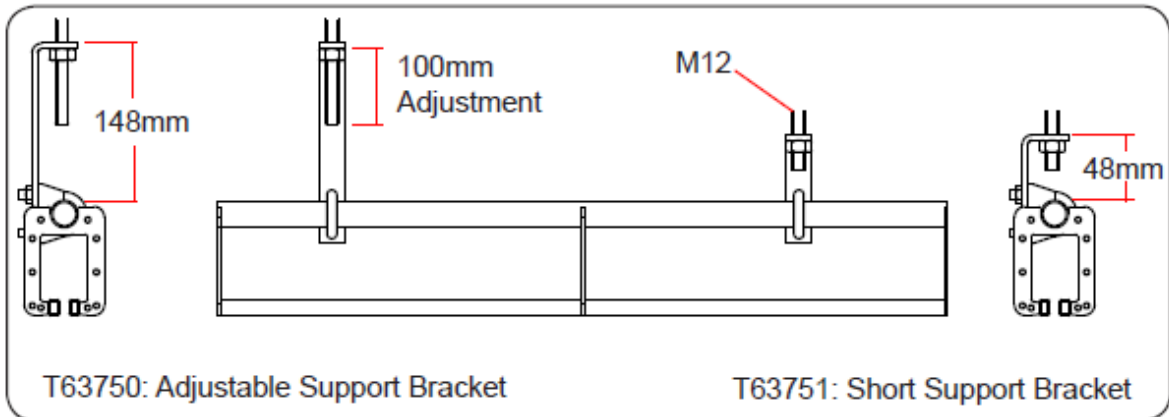

T63750: Adjustable Support Bracket

T63751: Short Support Bracket

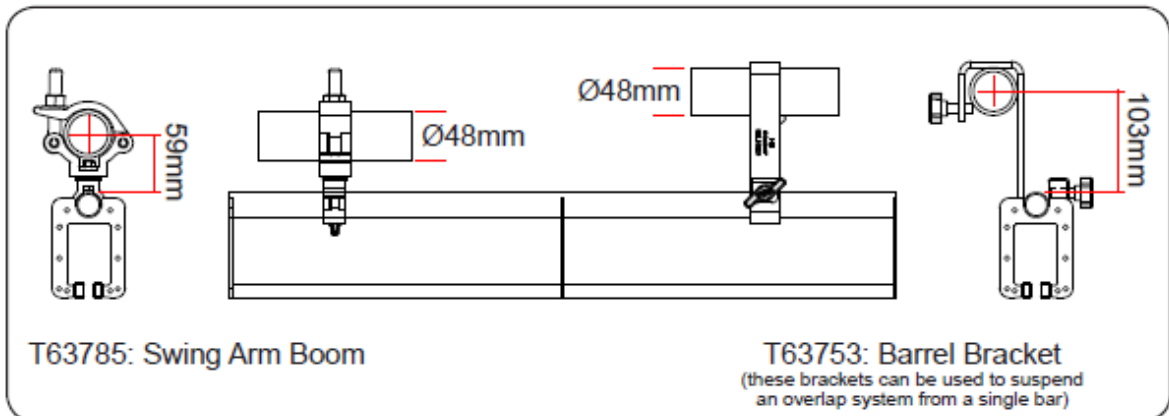

T63785: Swing Arm Boom

T63753: Barrel Bracket
(these brackets can be used to suspend an overlap system from a single bar)

Twin Tracks and Overlaps are spaced apart with purpose made brackets.

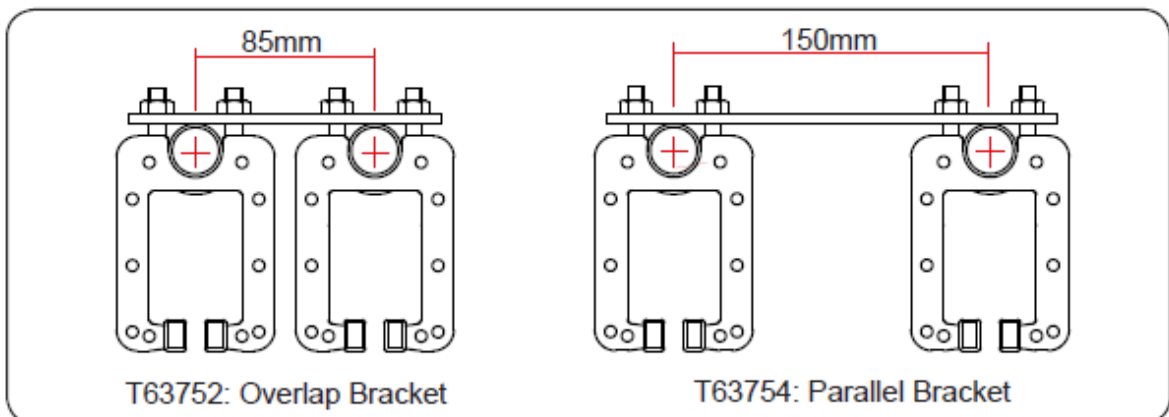

T63752: Overlap Bracket

T63754: Parallel Bracket

Walk-Along Systems - Single Swipe

Six Track walk-along systems are basic curtain tracks which are operated by moving the curtains by hand.

Listed below are the components required to make a system.

Check List:

1. Track Sections
2. Suspension Brackets
4. Curtain Runners
5. End Stops
6. Fixing Kit (for joining track sections)

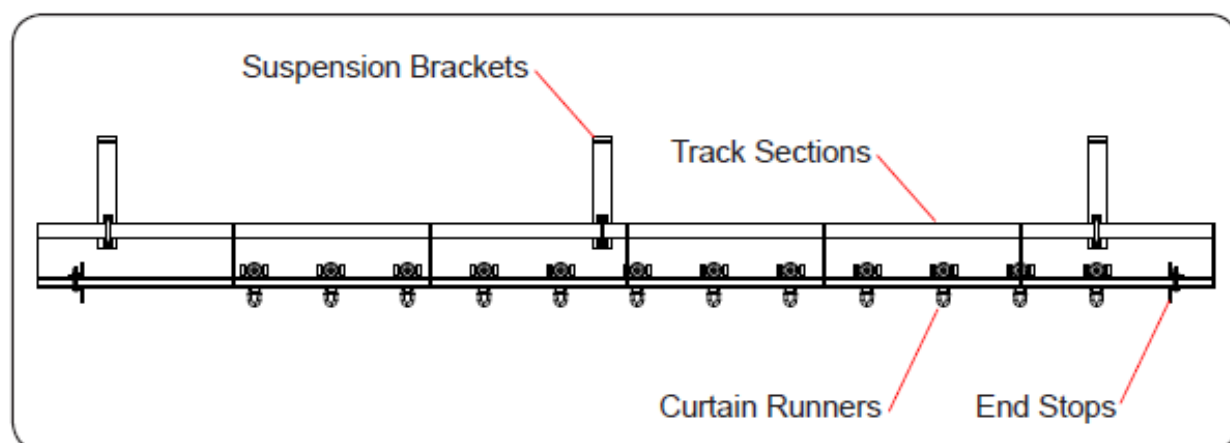

Walk-Along Track Kits

The following track kit include all the components to make a straight walk-along system. Each kit includes the recommended quantity of T63750 Adjustable Support Brackets. Contact sales@doughty-engineering.co.uk for a full component list.

T63941:	4.0m	Straight Kit	T63947:	10.0m	Straight Kit
T63942:	5.0m	Straight Kit	T63948:	11.0m	Straight Kit
T63943:	6.0m	Straight Kit	T63949:	12.0m	Straight Kit
T63944:	7.0m	Straight Kit	T63950:	13.0m	Straight Kit
T63945:	8.0m	Straight Kit	T63951:	14.0m	Straight Kit
T63946:	9.0m	Straight Kit	T63952:	15.0m	Straight Kit

Line Operated Systems - Single Swipe

Six Track line operated systems are curtain tracks which use a hauling line which is operated:

- a. By hand with a weighted or floor mounted pulley.
- b. With a manual track drive which can be either floor or wall mounted.

Listed below are the components required to make a system.

Check List:

1. Track Sections
2. Suspension Brackets
3. Master Runner
4. Curtain Runners
5. End Stops
6. Fixing Kit (for joining track sections)
7. Twin Head Pulley
8. Return Pulley
9. Weighted pulley, floor mounted pulley, wall mounted track drive or floor mounted track drive.
10. Hauling Line
11. Line Supports (if required)
12. Single Guide Pulleys (if required)
13. Twin Guide Pulleys (required for curves)

Line supports and single guide pulleys are recommended on systems 5.0m and longer.

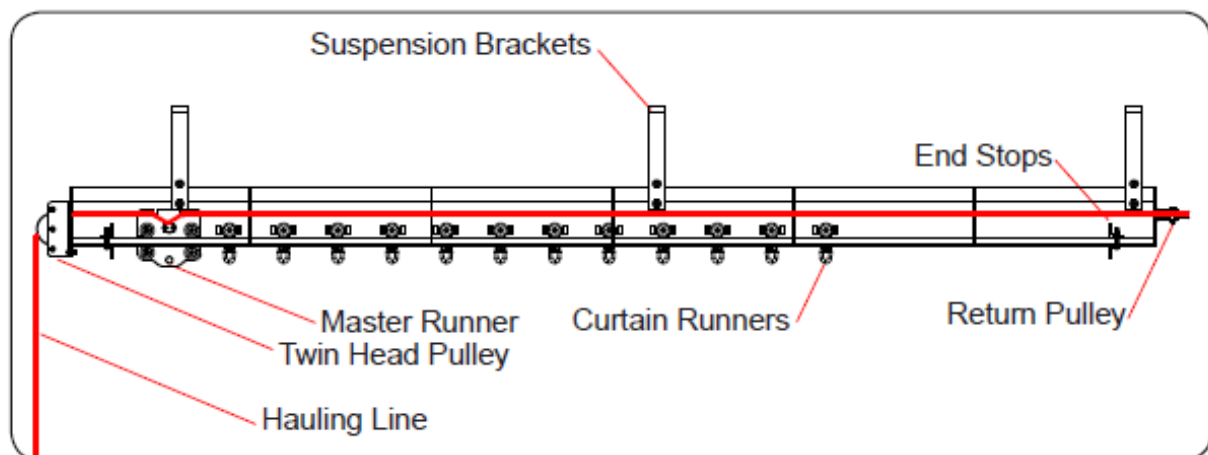

T63908:	4.0m	Straight Kit	T63914:	10.0m	Straight Kit
T63909:	5.0m	Straight Kit	T63915:	11.0m	Straight Kit
T63910:	6.0m	Straight Kit	T63916:	12.0m	Straight Kit
T63911:	7.0m	Straight Kit	T63917:	13.0m	Straight Kit
T63912:	8.0m	Straight Kit	T63918:	14.0m	Straight Kit
T63913:	9.0m	Straight Kit	T63919:	15.0m	Straight Kit

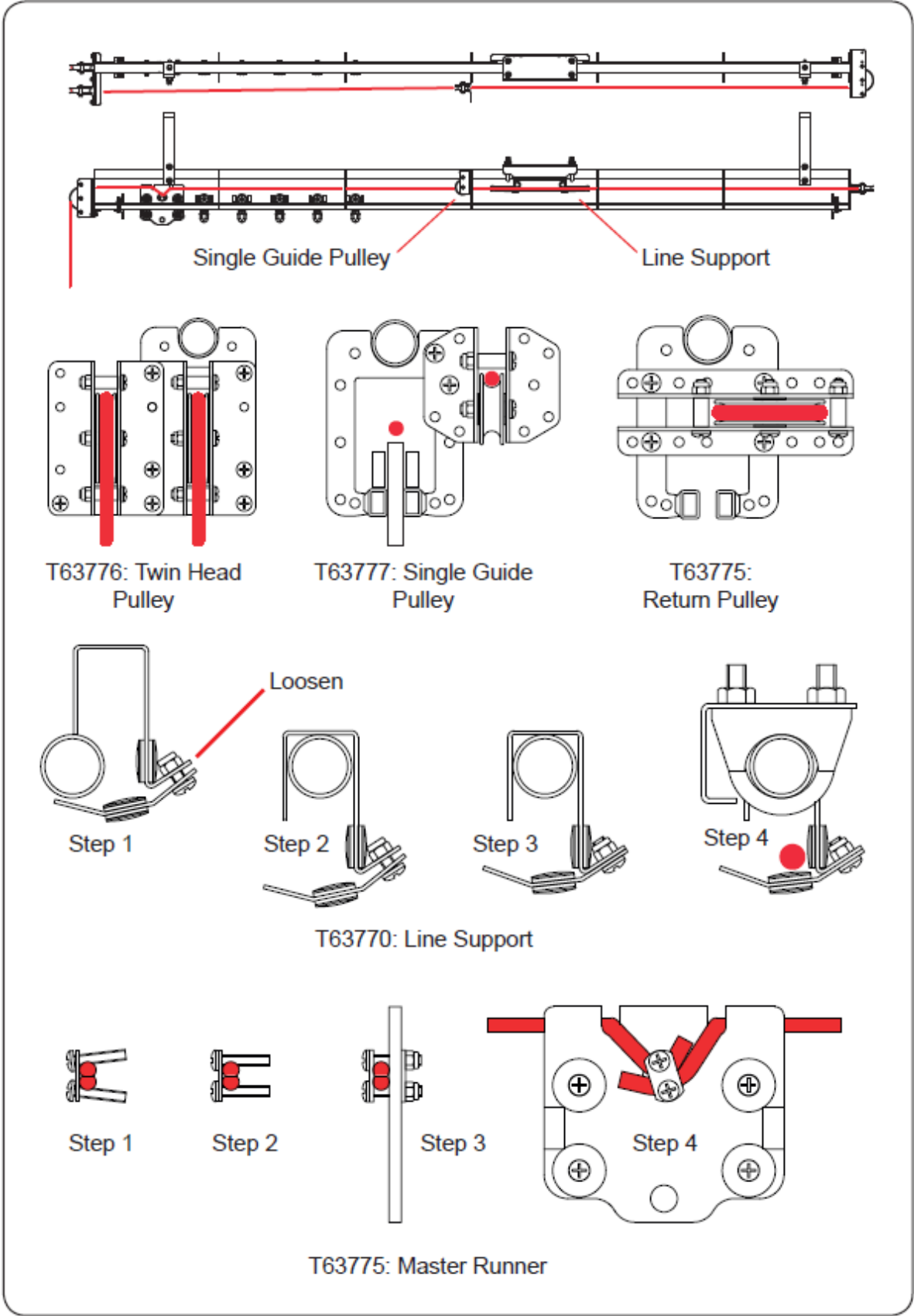

Line Operated Systems - Curves

Six Track line operated curves use double guide pulleys to guide the hauling line.

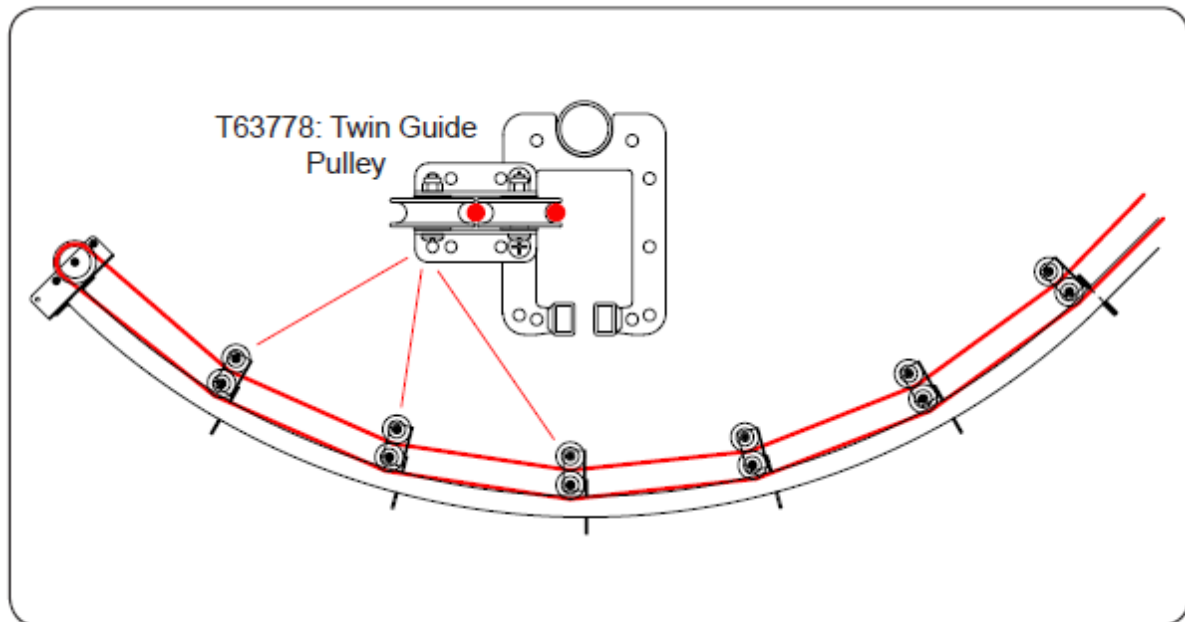

Line Operated Systems - Crossover

Systems containing two or more curves may require the hauling line to crossover to enable the correct routing. This is achieved using two T63777: Single Guide Pulleys as below.

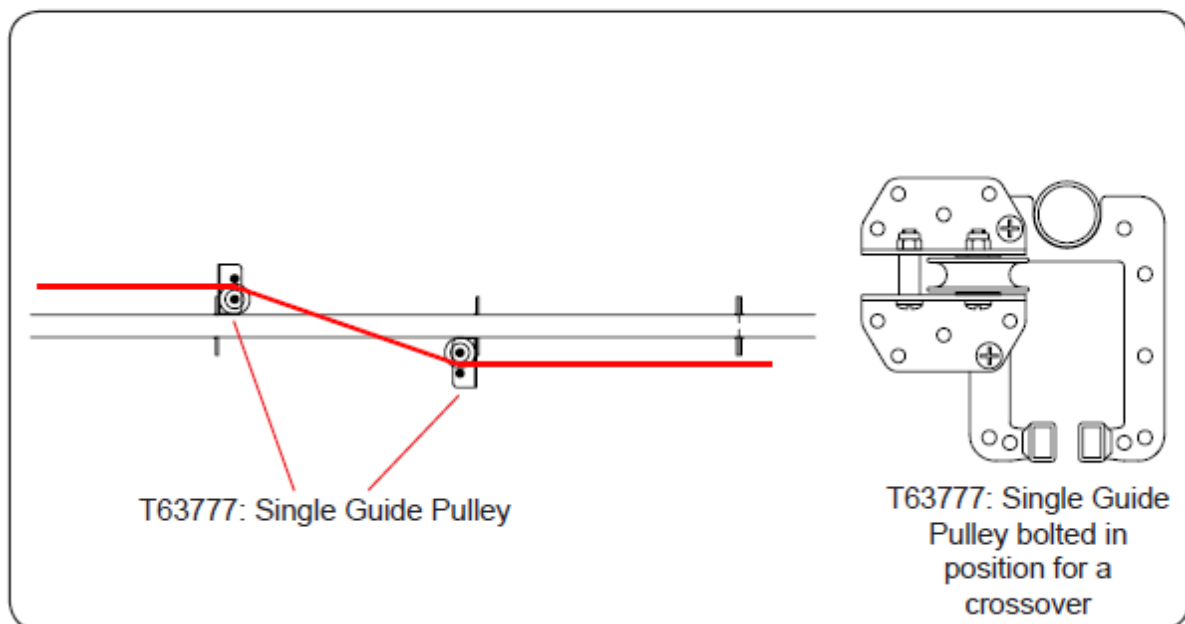

Line Operated Systems - Overlap

Six Track line operated systems can be installed in an overlap configuration. This configuration requires the use of overlap brackets and twin guide pulleys.

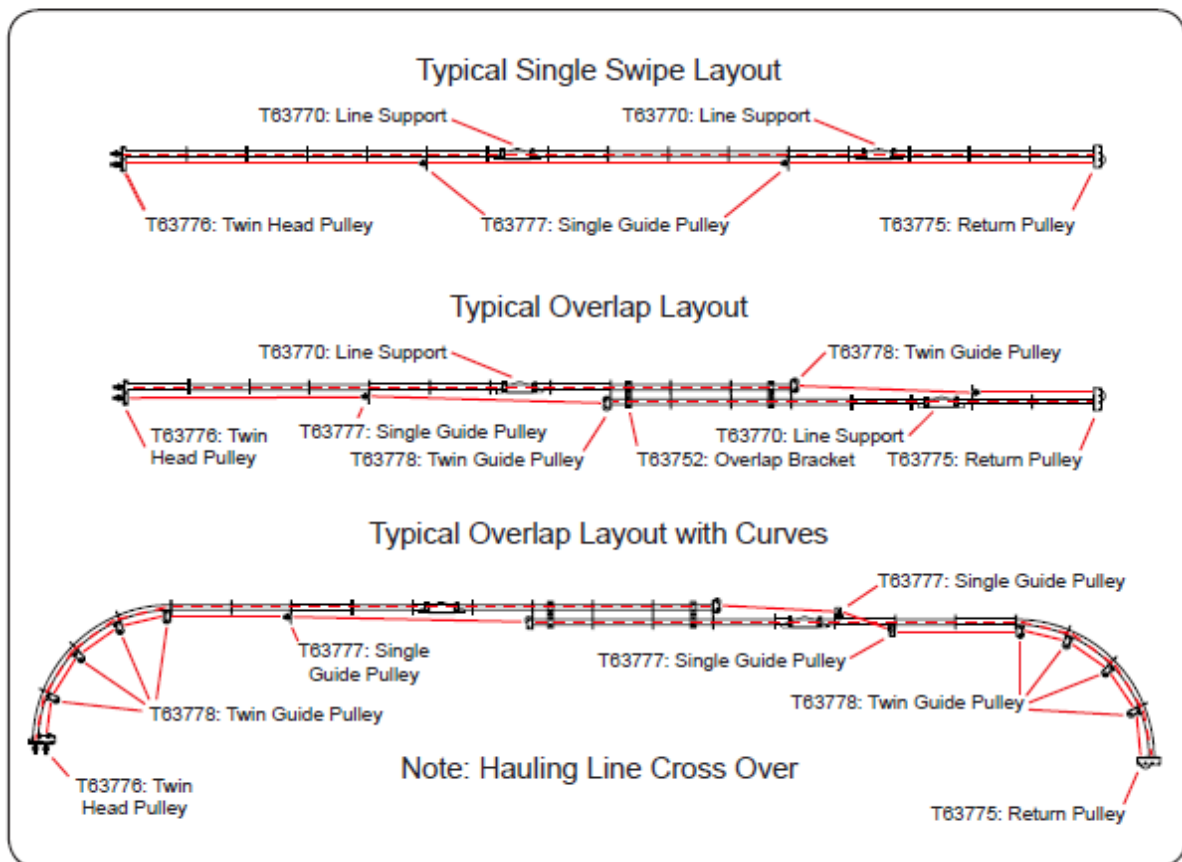
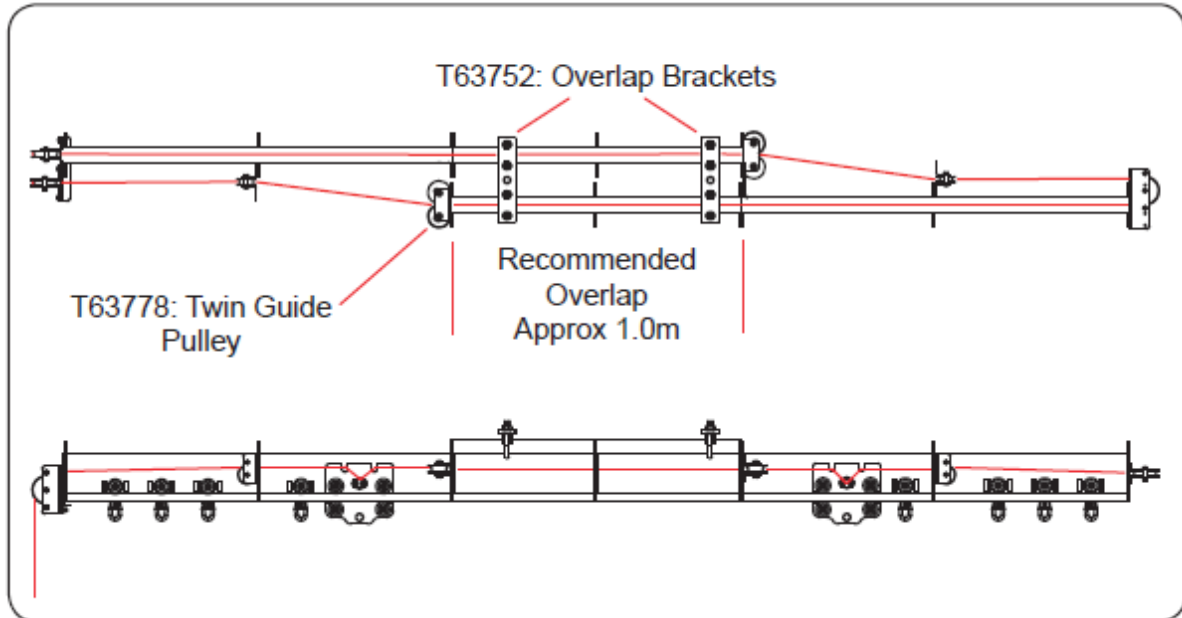

Line Operated Systems - Hand drives

Six Track line operated systems can be operated either by hauling hand over hand or by turning a crank handle of a manual track drive unit.

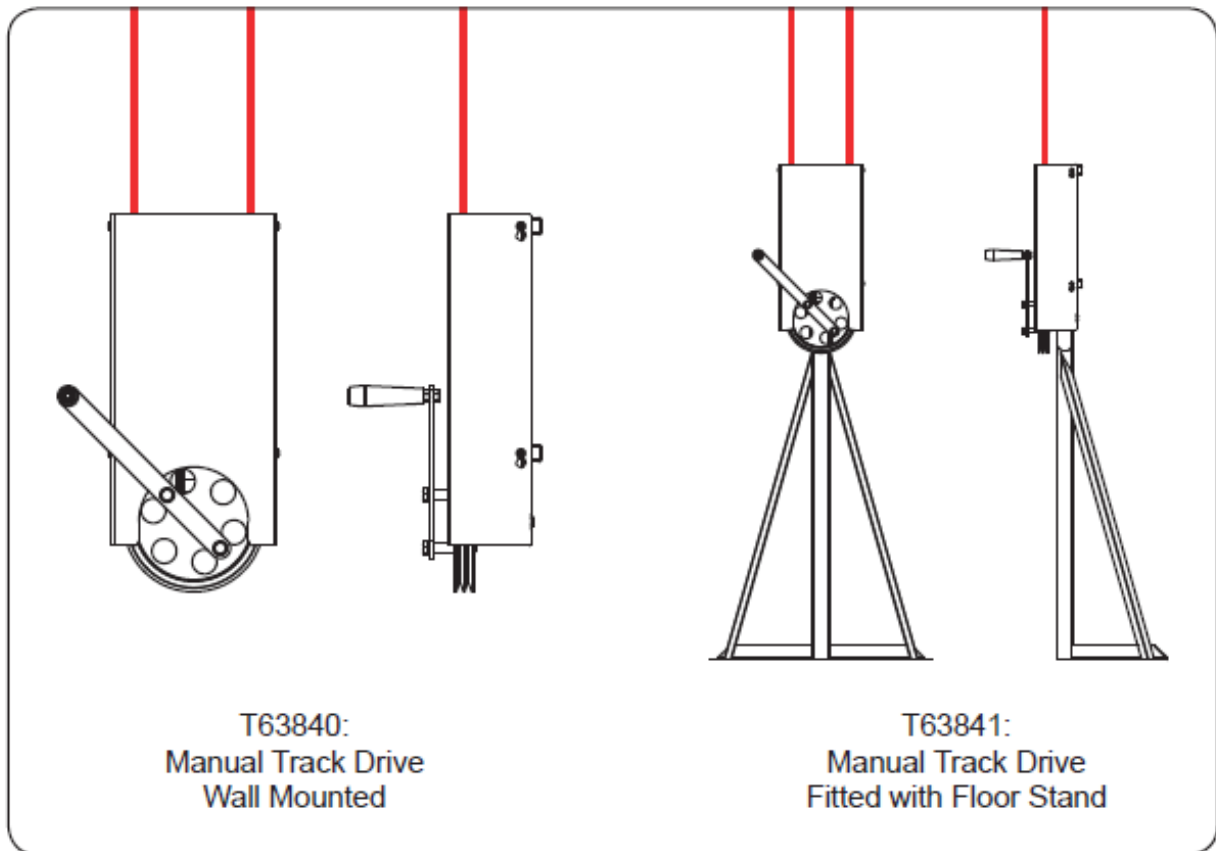
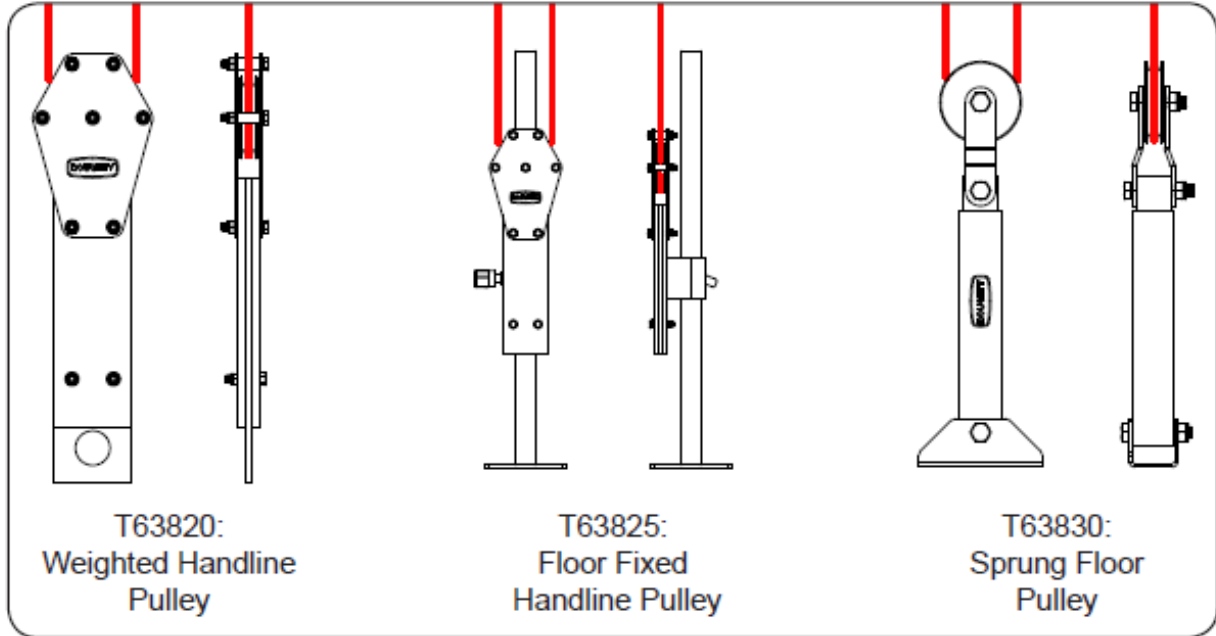

Routing the Hauling Line – Manual Drive Tracks

The diagram below shows the route of the hauling line through the guide pulleys and the line tensioner. The tensioner springs must be compressed during the routing of the hauling line and when released should remain partially compressed to compensate for any line stretch. Replace the cover using the six fixings before the drive is operated.

In the case of the loss of drive the hauling line will need re-tensioning. The following steps explain how to re-tension the hauling line.

1. Remove the cover by removing the six fixings
2. Compress the tensioner spring.
3. Loosen the rope clamp on the master runner.
4. Take up the slack line through the master runner.
5. Tighten the rope clamp on the master runner.
6. Release the tensioner spring ensuring it remains partially compressed.
7. Replace the cover.

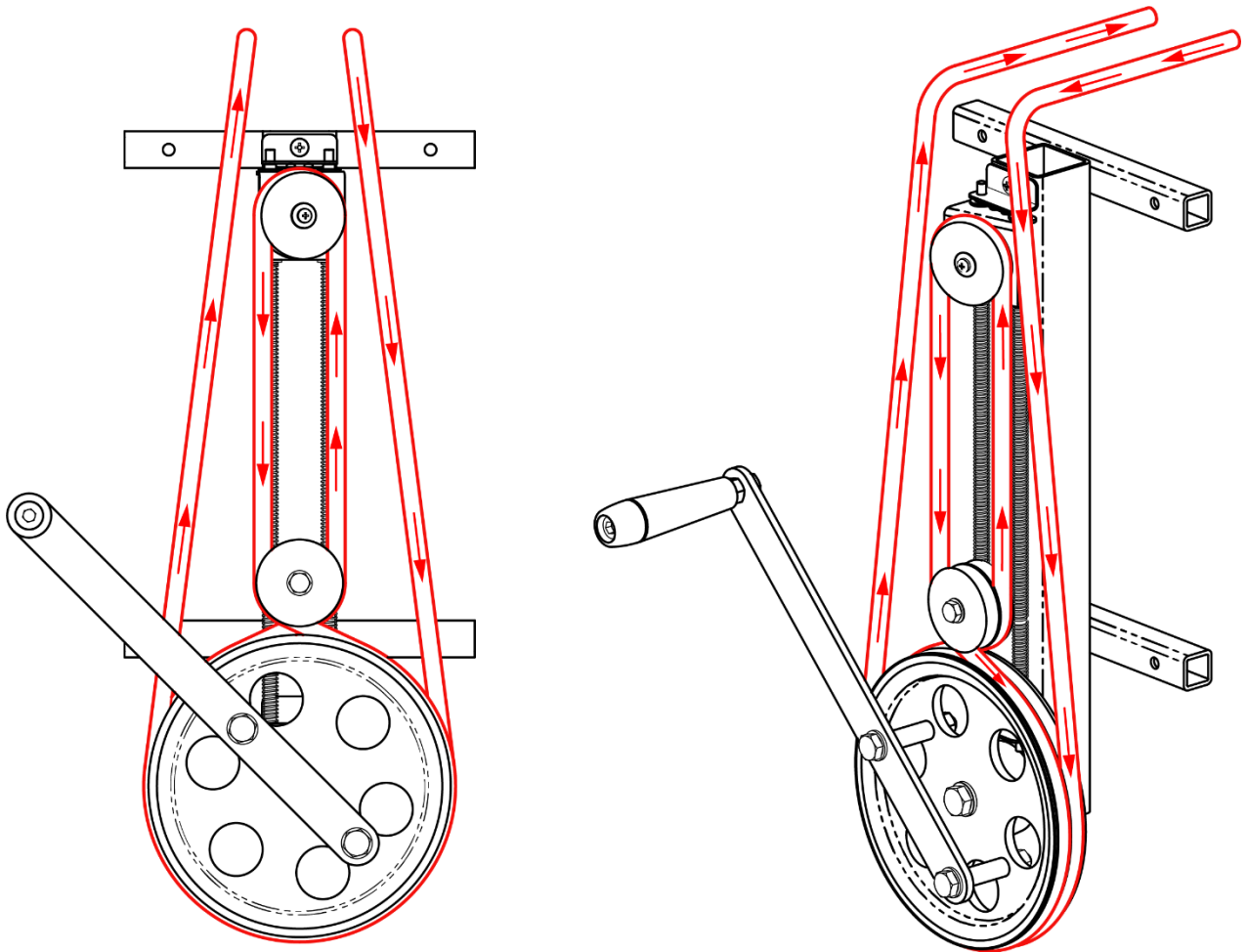

Variable Speed Curtain Track Drive (T63845)

The variable speed electric track drive is designed to be mounted on the end of Doughty Six Track rail. The power supply is 230 volts 50hz, single phase and must be fused at 5 amps. The unit is supplied with a mains plug to BS1363 incorporating a 5-amp fuse. Normal track speed is 0.75metres/second but this may be increased or decreased using the control box supplied. The maximum tractive effort is 20kg.

The drive unit can be bolted to the end of the rail in one of two positions as best suits the installation. The drive unit is fixed to the rail using 4 off M5 nuts.

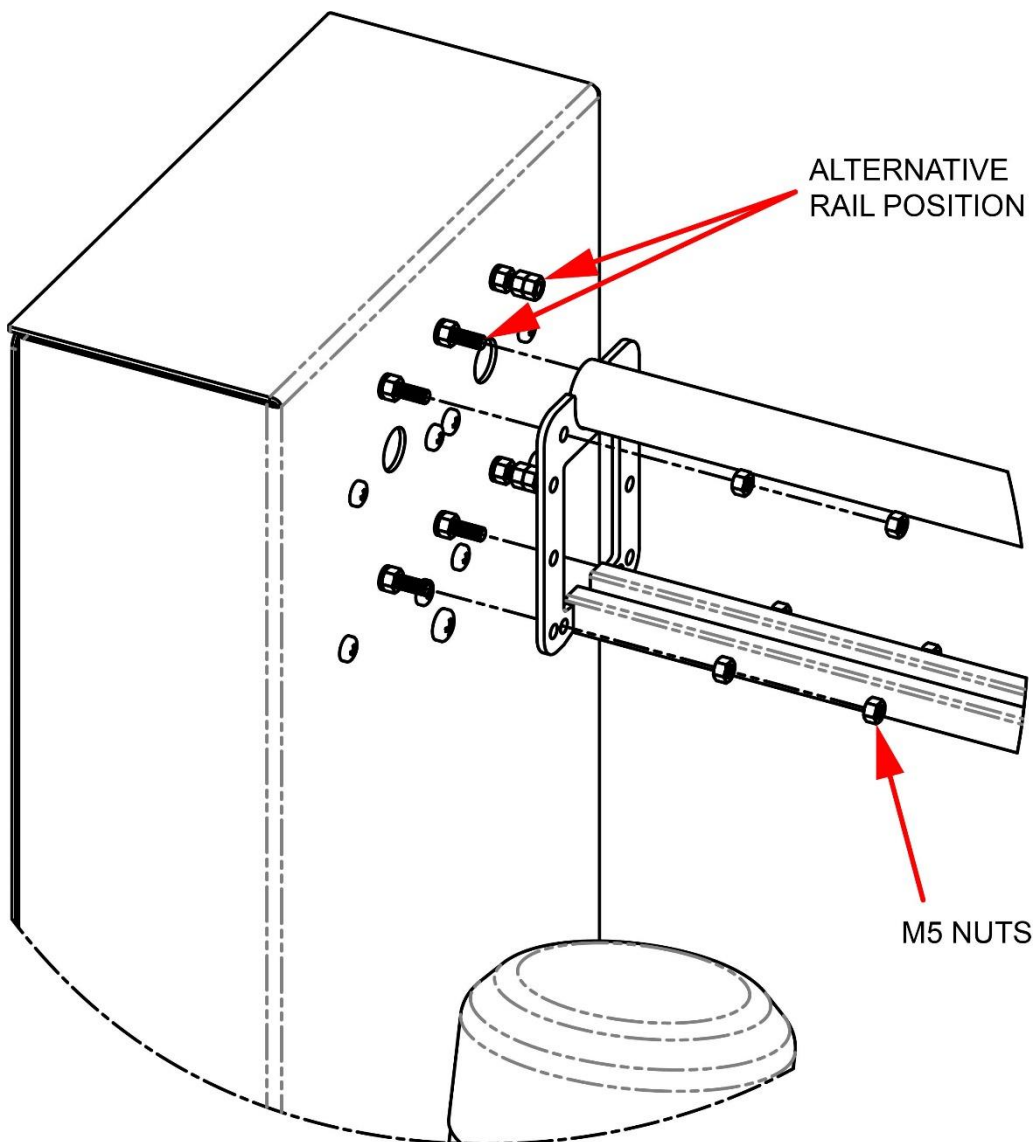

The rail should be supported with a suspension bracket within 60mm of the end of the rail and another within 300mm of the end.

Routing the Hauling Line

The diagram below shows the route of the hauling line through the guide pulleys and the line tensioner. The tensioner springs must be compressed during the routing of the hauling line and when released should remain partially compressed to compensate for any line stretch. Replace the cover using the six fixings before the drive is operated.

In the case of the loss of drive the hauling line will need re-tensioning. The following steps explain how to re-tension the hauling line.

1. **Disconnect the power lead.**
2. Remove the cover by removing the six fixings
3. Compress the tensioner spring.
4. Loosen the rope clamp on the master runner.
5. Take up the slack line through the master runner.
6. Tighten the rope clamp on the master runner.
7. Release the tensioner spring ensuring it remains partially compressed.
8. Replace the cover.
9. Re-connect the power and test.

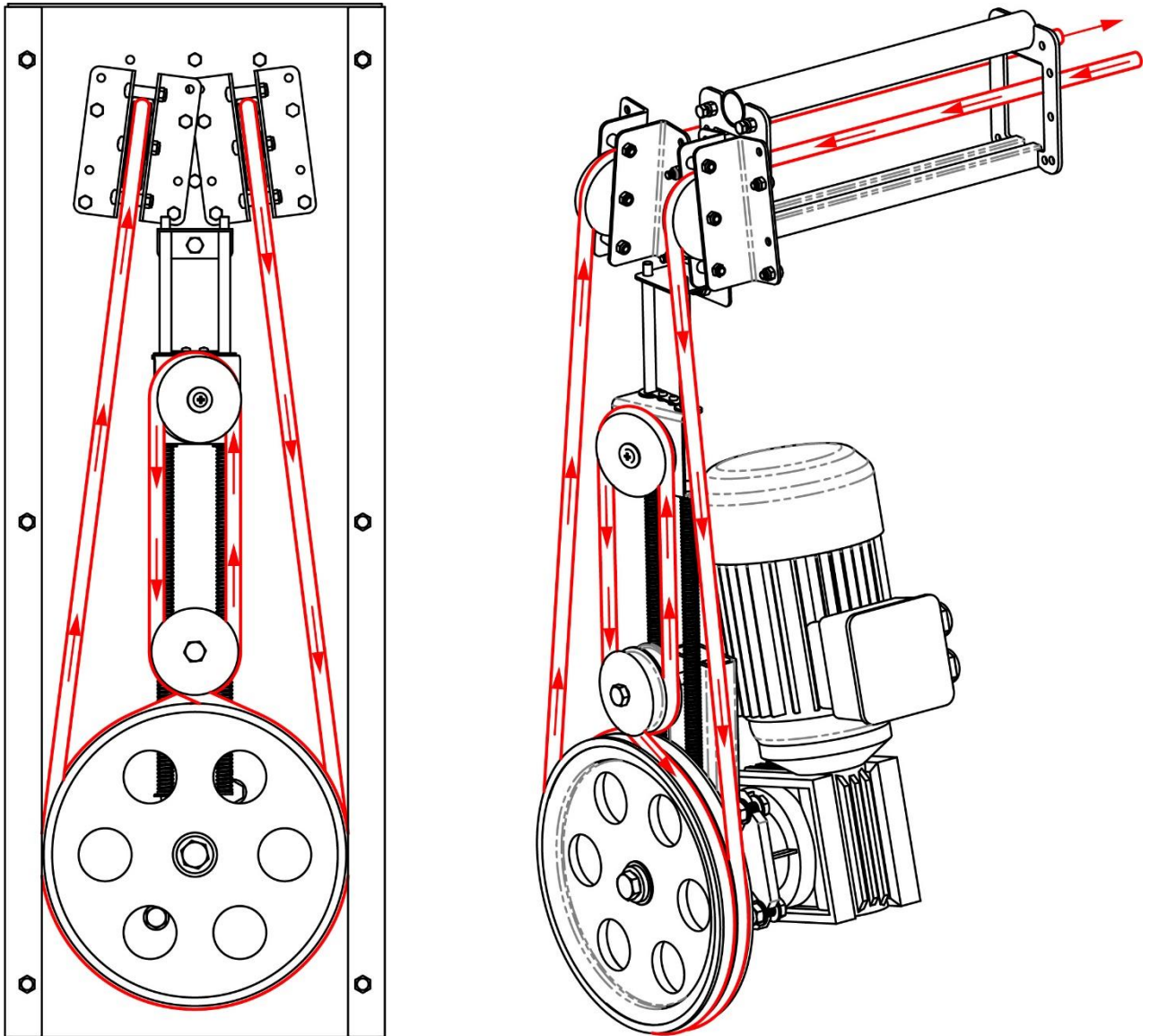

Electric Track Drive Limit Switches

Motorised track systems must be fitted with two limit switches. The limit switches are activated by the master runner and create the open and closed stopping positions for curtains or scenery.

The limit switches are mounted to the top tube of the rail using 2 off rail clamps and 'U' bolts. Limit switch wires are to be secured to the top tube of the rail using cable ties. Ensure that the limit switch wires are routed so that they cannot come into contact with any moving parts.

Limit switches are connected to the drive control box as shown in the circuit diagram (Fig.1).

The diagram below shows a typical limit switch installation on the track.

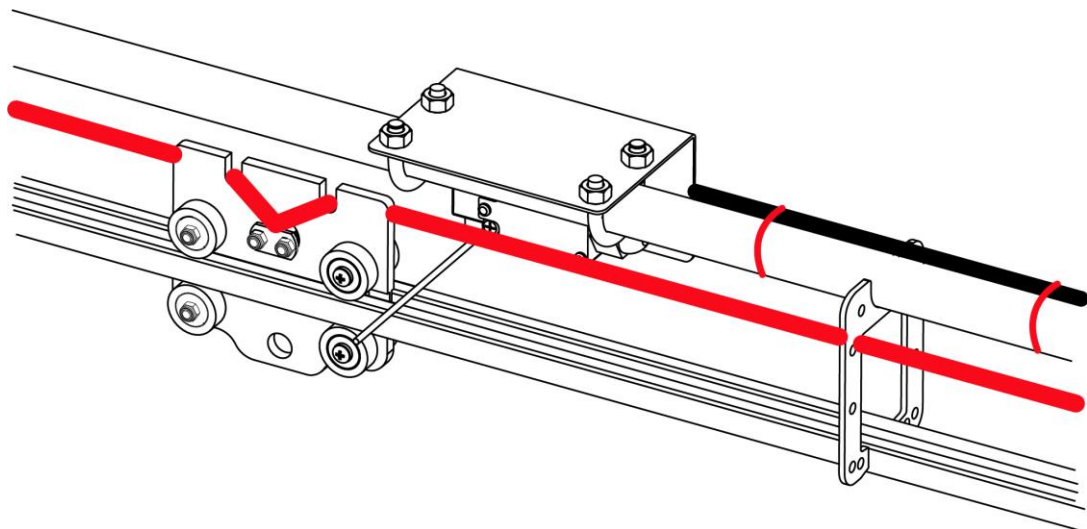

The limit switch arms must clear the rail profiles and so must be positioned on the rail with the 30mm and 125mm clearances shown below.

The master runner must also be oriented on the rail with the hauling rope clamp facing in the direction as shown below.

Failing to install the limit switches correctly can damage the track drive.

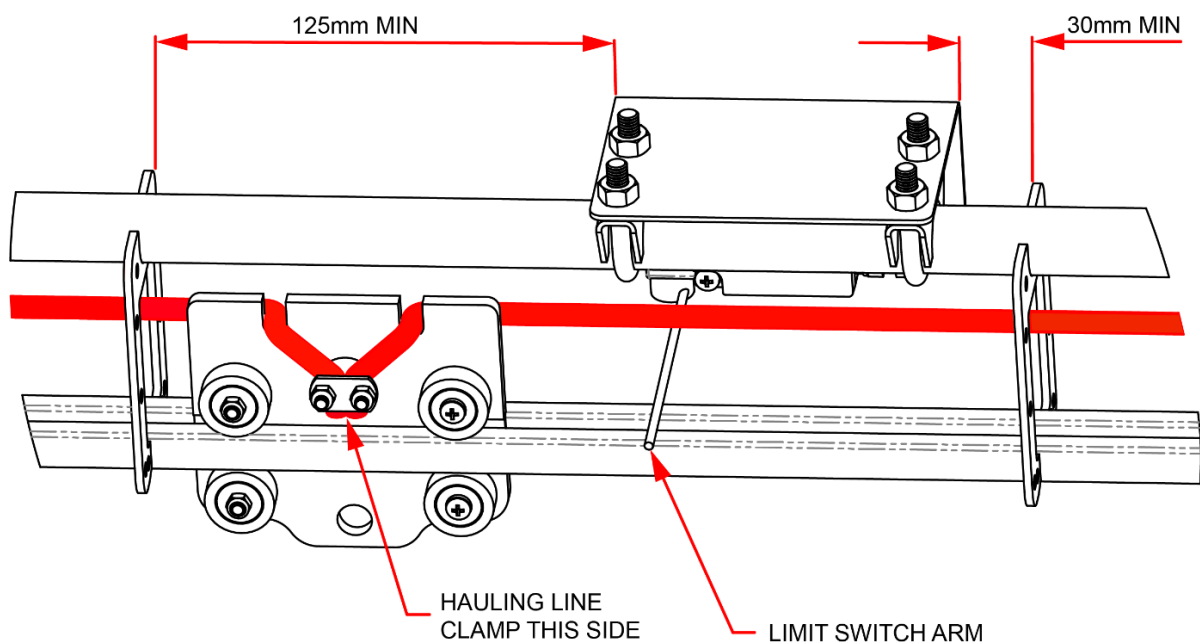

Local Control

The local control station has an emergency stop button which should be pushed in to isolate the drive except when the drive is in use.

Ten metres of screened cable is provided for connection to the motor.

Connecting points are provided for the limit switches.

Connecting points are provided for the optional remote control.

The control functions are as follows:

- Emergency stop which switches the control off completely.
- 'Open' and 'close' buttons.
- Local/remote control selector switch.
- Power on indicator.

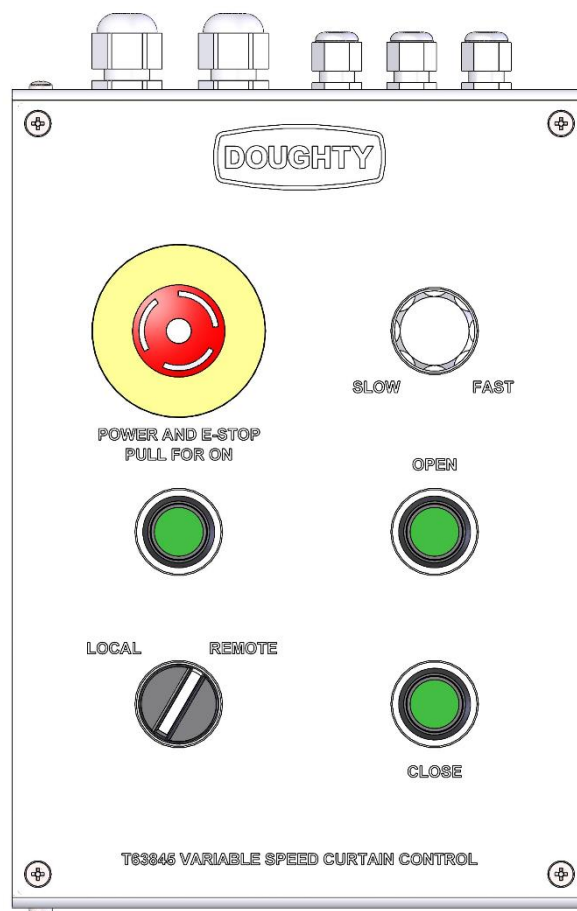

Optional Remote Control

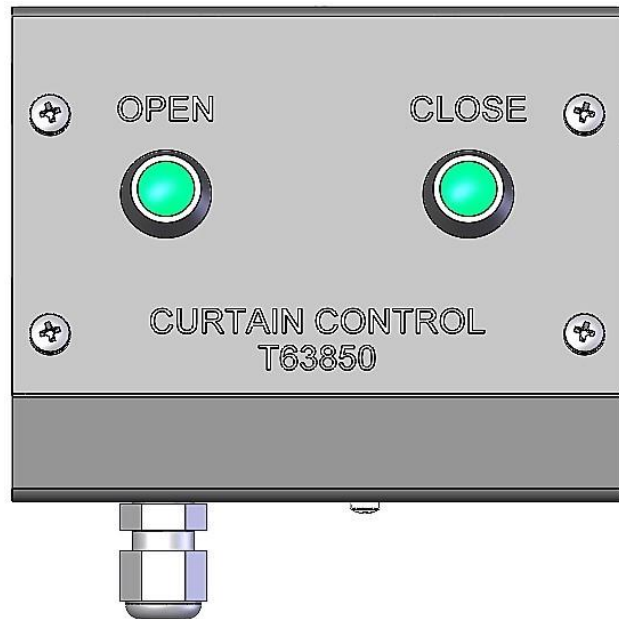
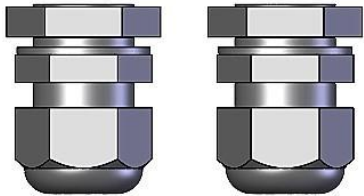
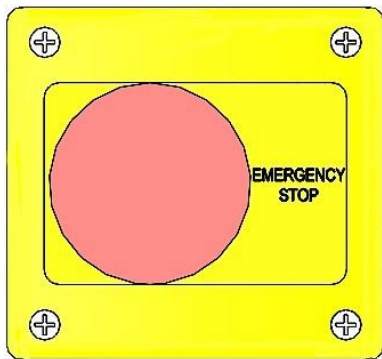

The optional remote-control station comprises a control box having 'open' and 'close' buttons for operation of the drive from a remote position.

Twenty metres of cable is provided with the remote control.

A remote 'emergency stop' control is provided for mounting near the remote-control box. This control cuts the mains supply to the local control to provide an independent emergency stop.

Ten metres of cable is provided with the emergency stop.

Circuit Diagram (Fig.1)

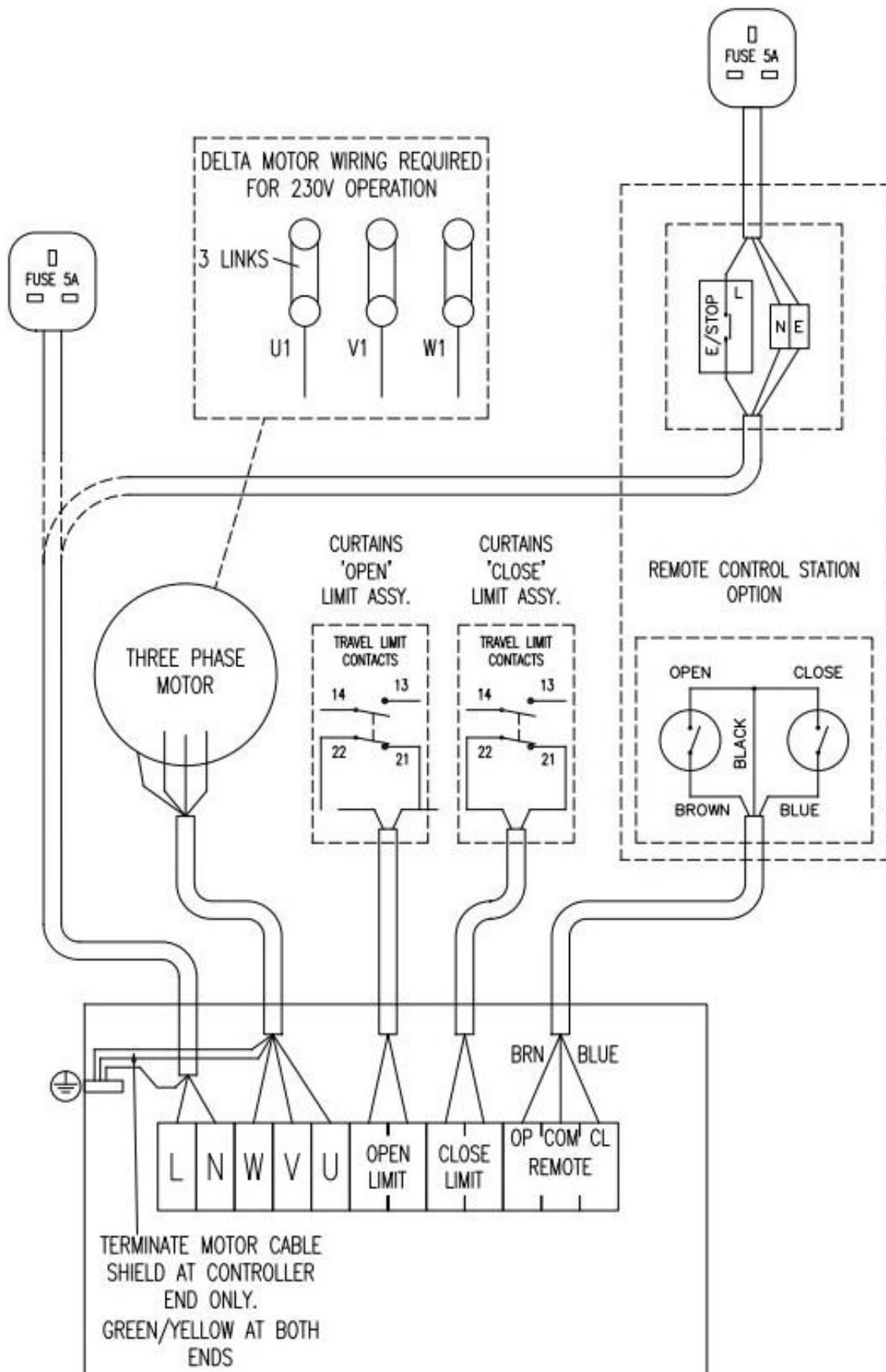

9) COMMISSIONING

Upon installation record the following:

- Type of Six Track.
- Place and date installed.
- Name and title of installer and organisation.
- Estimated number of operations each week.

10) MAINTENANCE & INSPECTION

Maintenance must only be carried out by approved personnel.

Approved personnel must make regular checks of the product.

If any damage is seen, including cracks, deformation or missing parts, the product must be removed from service and returned to an Approved Service Agent for evaluation/repair.

A full list of approved service agents can be found at www.doughty-engineering.co.uk.

Approved personnel must carry out a visual inspection and a functional test before every use.

Approved personnel must carry out more detailed inspection and testing of the product on a regular basis depending on the usage of the product.

Written records should be kept from the date the product is put into operation.

RECORDS

An inspection table can be found at the back of this manual where the maintenance and inspection history of the Six Track can be recorded.



The installer/operator must read and understand the instruction manual before using the equipment. Operators should be adequately instructed and fully understand the safe use of the equipment before use.

Failure to carry out maintenance as necessary, including the replacement of parts to the correct standard could render the equipment unsafe and the manufacturer cannot accept any responsibility in this respect.

Do not use this equipment for a purpose that it is not intended.
Retain this manual for future reference.

11) IF THE PRODUCT IS NO LONGER NEEDED

Products that are no longer needed can be scrapped. Preferably remove all steel parts, store part separately before offering them to a scrapping company.

The following alloys are used:

- Mild Steel 8.8

12) WARRANTY

- For a period of 12 months we undertake to repair, free of charge any damage attributable to faulty materials or workmanship, provided that the appliance is forwarded, freight paid, to our works or one of the Doughty appointed service agents.
- The guarantee-period begins on the day of the delivery, proven by a purchase receipt like an invoice or delivery note or their copies.
- The guarantee only is applicable for new equipment.
- The guarantee does not cover damage due to transport damage, negligent handling, overload or parts subject to normal wear and tear. Nor damages that originate from a case of misuse because of non-observance the instructions in this manual.
- The fitting of non-original replacement parts or modifications of design by third parties invalidates the guarantee.
- Guarantee repairs do not renew nor extend the guarantee-period.
- In case of a claim under the guarantee or spare part requirements please contact your Doughty service agent.
- The manufacturer is not liable for indirect consequential damage or financial loss.
- The manufacturer is not liable for any changes made to the Six Track or for any damage resulting from such changes.

13) INSTALLATION / INSPECTION REPORT

Installation

Part No.....	Serial No.....
Customer.....	Location.....
Installation Company.....	
Installed By	

Inspection

INSPECTED BY	DATE	ESTIMATED OPERATIONS	NOTES	SIGNATURE

14) EC DECLARATION



Engineering Ltd

EC-DECLARATION OF CONFORMITY

According to the Machinery Directive 2006/42/EEC Annex II

Doughty Engineering Ltd
Crow Arch Lane
Ringwood
Hampshire
BH24 1NZ

Herewith declares that:

Six Track Range

are in compliance with the following harmonized standards/standards/regulations

Machinery Directive 2006/42/EEC annex II

BS7905-1:2001 Lifting equipment for performance, broadcast and similar applications

DGUV 17 Safety at production & events for television, radio, film, theatre, exhibitions and loads above persons

Signed for and behalf of **Doughty Engineering Ltd**

Name **Stuart Rodgers** Date 02/10/2019

A handwritten signature in blue ink, appearing to read "Stuart Rodgers".

Position **General Manager** being the person responsible appointed by the manufacturer.

Company Registration No. London 972614
Registered Office: Crow Arch Lane, Ringwood, Hants, BH24 1NZ
Directors: M.B. Lister. J.C.G. Chiverton. S.C. Wright